

# Type M85 Sliding Folding Partition Data



# General Product Information

The Type 85 Sliding Folding Partitions are generally supplied as bottom supported with acoustic insulation up to Rw52dB.

Panels are secured in position by means of an internal mechanism and move effortlessly along an aluminium head and floor track. When closed they form a secure fixed wall, normally incorporating a pass door as the leading panel to allow easy access between rooms.

<b>Max Panel Width</b>	900mm	<b>Track Finish</b>	Head - RAL 9016 White Floor – SAA Threshold
<b>Min Panel Width</b>	450mm	<b>Std Profile Finish</b>	SAA – M85
<b>Max Panel Height</b>	4000mm	<b>Max Wing Width</b>	Ideally 7000mm but 10000 mm possible subject to acoustic rating, stacking and height
<b>Min Panel Height</b>	1500mm	<b>Std Wall Jamb</b>	65mm - RAL 9016 White
<b>Panel Thickness</b>	85mm	<b>Panel Weights</b>	From 30 – 45 kgs Per Sq M
<b>Decibel Rating</b>	35 - 52		
<b>Configuration</b>	Single & Double Wing Bi-parting (Rollers can be end, eccentric or centre)		
<b>Seals</b>	Acoustic Bulb Seal with additional foam insert		

# Standard Sections

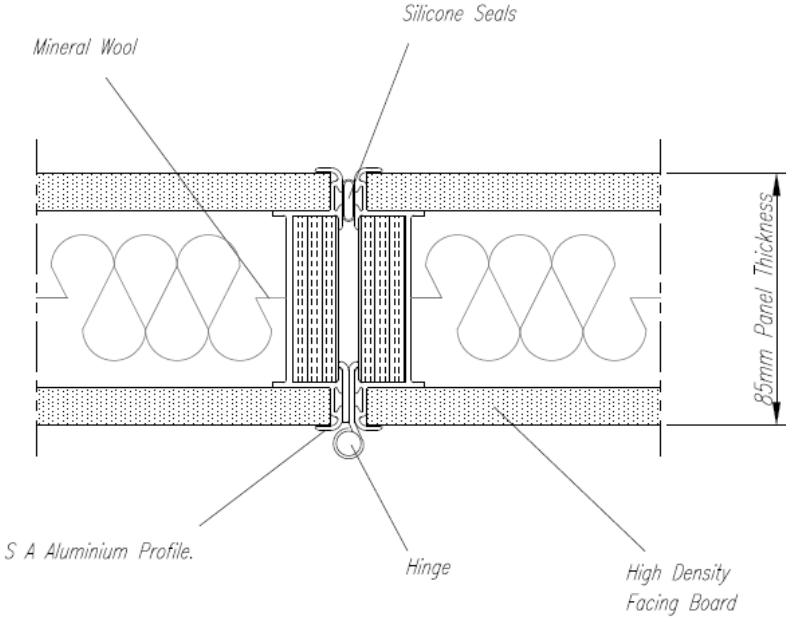
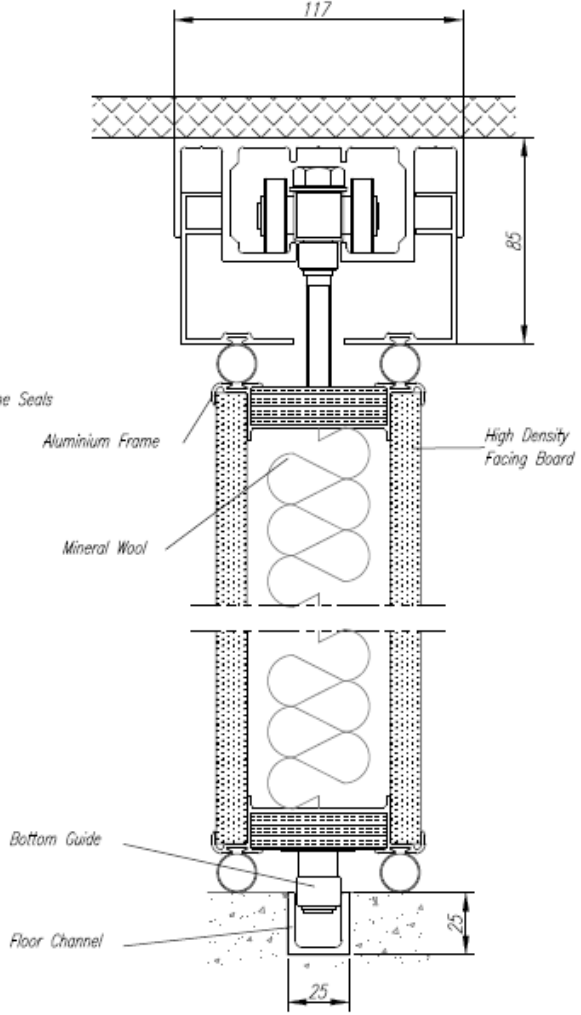
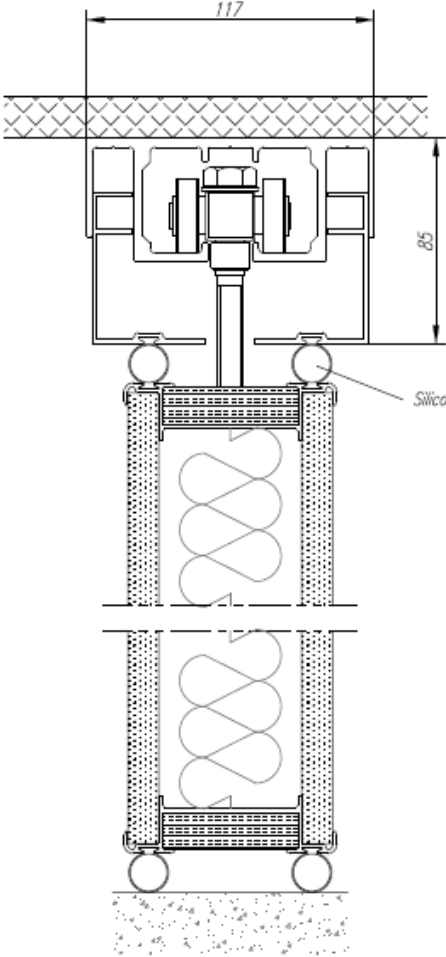
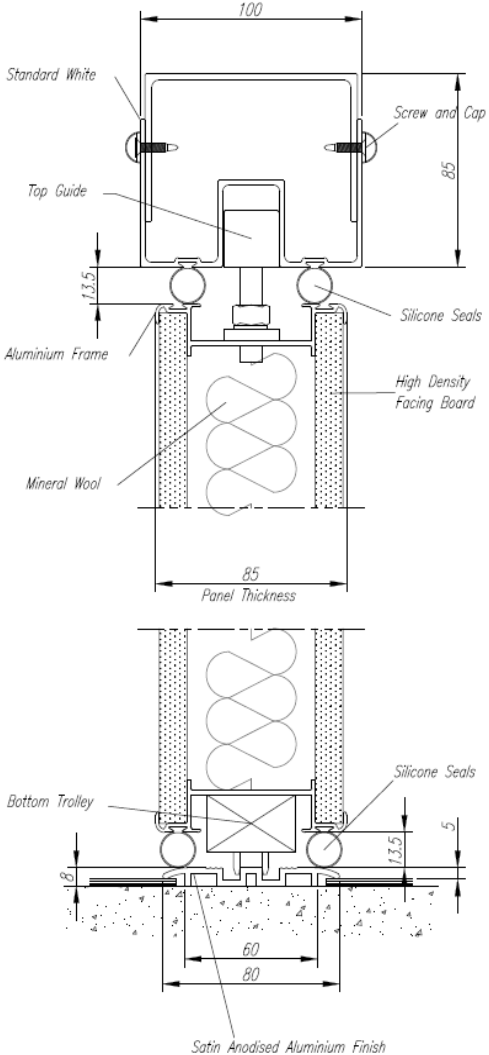

# Additional Details

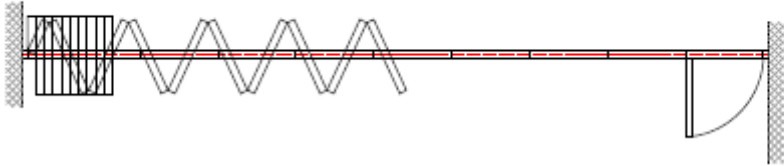

*CENTREFOLD TO ONE SIDE*

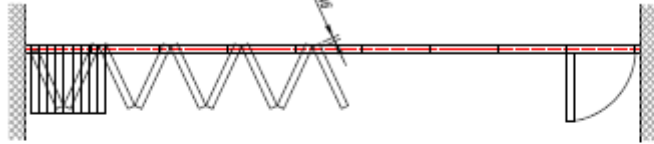

*ENDFOLD TO ONE SIDE  
46mm OFFSET*

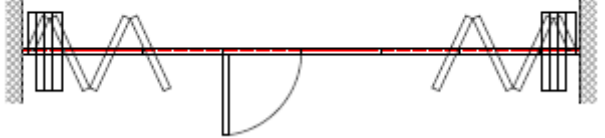

*CENTREFOLD BI-PARTING*

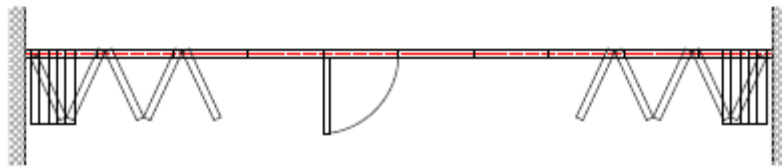

*ENDFOLD BI-PARTING*

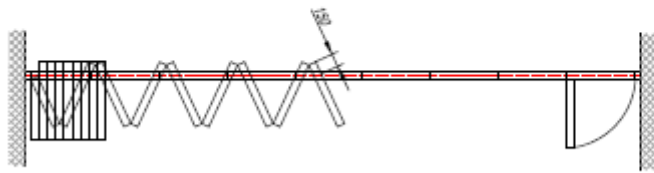

*ENDFOLD TO ONE SIDE  
150mm OFFSET*

# Stock Plain Colour Finishes

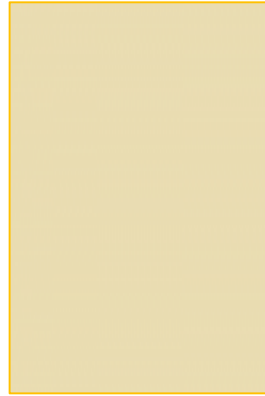

Cream

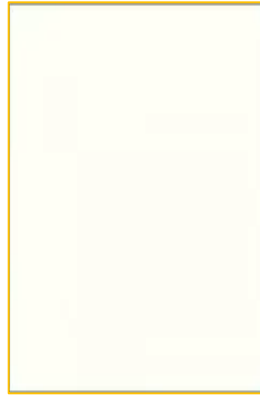

White

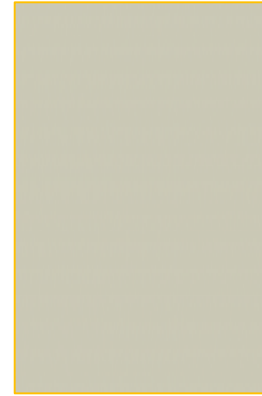

Light Grey

For projects with 5 panels or more, we are able to offer a wider range of colours from the White, Plain Colour or Woodgrains from [www.geaves.com/melamine-board/duhospan](http://www.geaves.com/melamine-board/duhospan) at no extra charge. Gloss, High Pressure Laminate or Real Timber Veneer is available at extra cost.

# Stock Woodgrain Finishes



Birch



Ash



Maple



Beech



Oak

For projects with 5 panels or more, we are able to offer a wider range of colours from the White, Plain Colour or Woodgrains from [www.geaves.com/melamine-board/duhospan](http://www.geaves.com/melamine-board/duhospan) at no extra charge.

Gloss, High Pressure Laminate or Real Timber Veneer is available at extra cost.

**Multispace Systems Type 85 Folding Partitions**